

J.L. WINGERT CO.

Instruction Sheet BYPASS FEEDER VALVE PACKAGE

IS032001.A 11/15

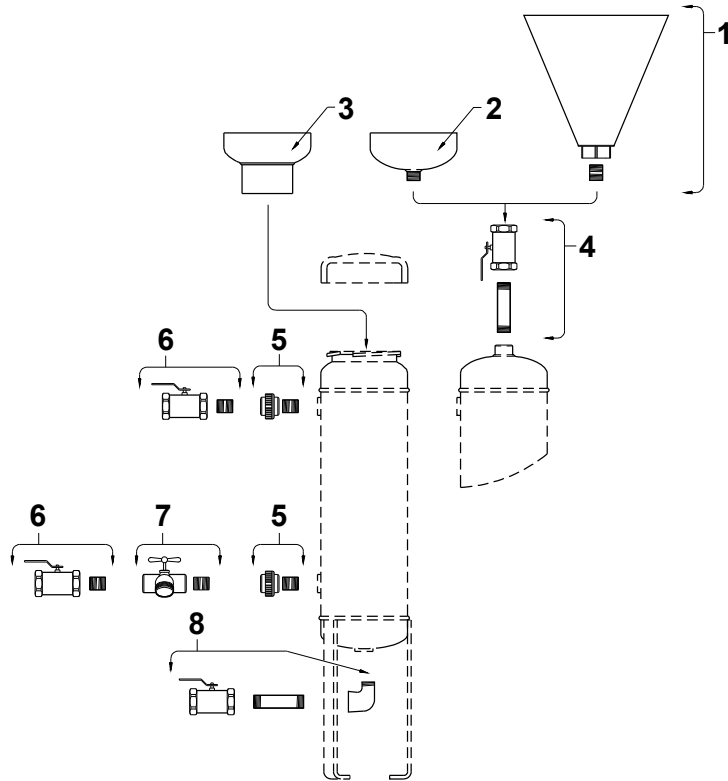

SPECIFICATIONS

KEY	PART NUMBER	DESCRIPTION
1	3069P	PE FUNNEL: 10" diameter polyethylene fill funnel
2	3069	FUNNEL: 6" diameter carbon steel fill funnel
3	3218	FUNNEL: 6" diameter carbon steel fill funnel with spill guard
4	3142	FILL VALVE: 1" NPT 300 PSI brass ball valve and 5" black nipple
5	3079	UNION: 3/4" NPT 300 PSI black union valve and installation nipple
6	3141	ISOLATION VALVE: 3/4" NPT 300 PSI brass ball valve and installation nipple
7	3063	HOSE BIBB: 3/4" NPT 300 PSI hose bibb with installation tee and nipple
8	3143	DRAIN VALVE: 3/4" NPT 300 PSI brass ball valve with installation street elbow and nipple

VALVE PACKAGES

PART NUMBER	DESCRIPTION	INCLUDES KEY NUMBERS
3138	Flat bottom valve package	(2) #5 (2) #6 (1) #7
3138F	Flat bottom valve package with fill funnel	(1) #3 (2) #5 (2) #6 (1) #7
3139	Dome bottom valve package	2) #5 (2) #6 (1) #8
3139F	Dome bottom valve package with fill funnel	(1) #3 (2) #5 (2) #6 (1) #8
3140	High pressure valve package with steel funnel	(1) #2 (1) #4 (2) #5 (2) #6 (1) #8
3140P	High pressure valve package with PE funnel	(1) #1 (1) #4 (2) #5 (2) #6 (1) #8

UNPACKING:

- 1) Ensure that there has been no damage in shipping. If any damage has occurred, please notify the freight carrier and the J. L. Wingert Co. immediately.

INSTALLATION:

- 1) Assemble valves and fittings as shown on the diagram above.
- 2) Wingert Bypass Feeders and Pleated Filter Feeders should be installed with the inlet at the lower side entry. Wingert Filter Feeders should be installed with the inlet at the upper side fitting.

The J.L. Wingert Co. offers a full line of feeder accessories such as sight flow indicators, air release valves, and filter bag kits. See our product brochure or call our customer service department for help with your application.

Note: All dimensions are +/- 1/8". All dimensions are subject to change without notice.

MANUFACTURING: Mixers, Bypass Feeders, Filter Feeders, Bromine Feeders, Sample Coolers, Sludge Traps, Separators, Separator Systems, Tank Stands, Tank Package Systems, Glycol Feed Systems, Coupon Racks, Control Stations, NEMA Enclosures, Custom Packaged Systems and Specialty Welding

P.O. Box 6207 | Garden Grove, CA 92846-6207 | 11800 Monarch St. | Garden Grove, CA 92841-2113 | Phone (714) 379-5519 | Fax (714) 379-5549
Northern California Region | Phone (510) 487-5310 | Southwest Region | Phone (602) 470-1015 | Email: customerservice@jlwingert.com

www.jlwingert.com