

J.L. WINGERT CO.

Specification Sheet CLEAR PVC Y-STRAINER AND NIPPLE OPTION 04

SS163504.C 11/15

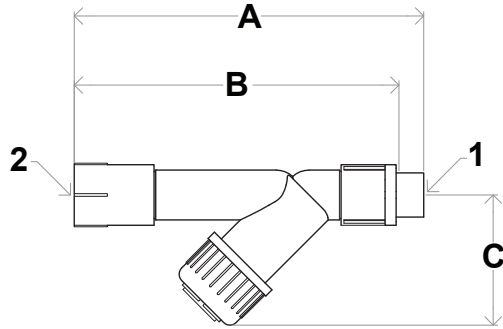

KEY	DESCRIPTION	
1	INLET	3/4" MNPT
2	OUTLET	3/4" FNPT

DIMENSION	MODEL
	PCR-__-007
A	7 15/16"
B (Installed Length)	7 7/16"
C	2 15/16"

TEMPERATURE (°F / °C)	NON-SHOCK PRESSURE RATING	
	PVC	
	PSI	BAR
73° / 23°	150.0	10.4
90° / 32°	112.5	7.7
110° / 43°	75.0	5.2
130° / 54°	45.0	3.1
150° / 66°	N/A	N/A
200° / 93°	N/A	N/A
250° / 121	N/A	N/A

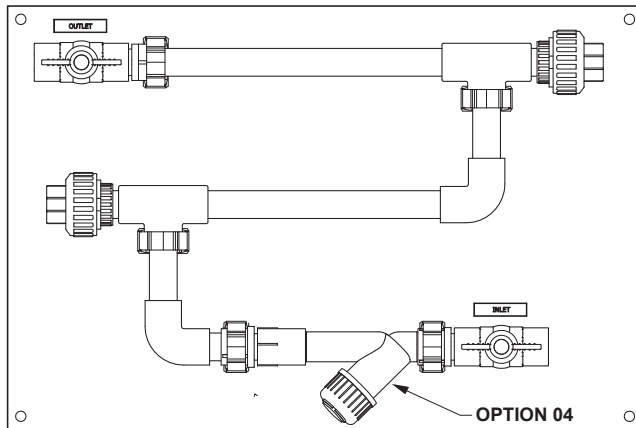

EXAMPLE OF OPTION 04 ON PCR-2-007/04

**Note: All dimensions are +/- 1/8". All dimensions are subject to change without notice.
See Operation & Maintenance Manual for part numbering.**

MANUFACTURING: Mixers, Bypass Feeders, Filter Feeders, Bromine Feeders, Sample Coolers, Sludge Traps, Separators, Separator Systems, Tank Stands, Tank Package Systems, Glycol Feed Systems, Coupon Racks, Control Stations, NEMA Enclosures, Custom Packaged Systems and Specialty Welding

P.O. Box 6207 | Garden Grove, CA 92846-6207 / 11800 Monarch St. | Garden Grove, CA 92841-2113 | Phone (714) 379-5519 | Fax (714) 379-5549
Northern California Region | Phone (510) 487-5310 | Southwest Region | Phone (602) 470-1015 | Email: customerservice@jllwingert.com

www.jllwingert.com