

# J.L. WINGERT CO.

## Specification Sheet BYPASS FEEDER VALVE PACKAGE

SS032001.A 11/15

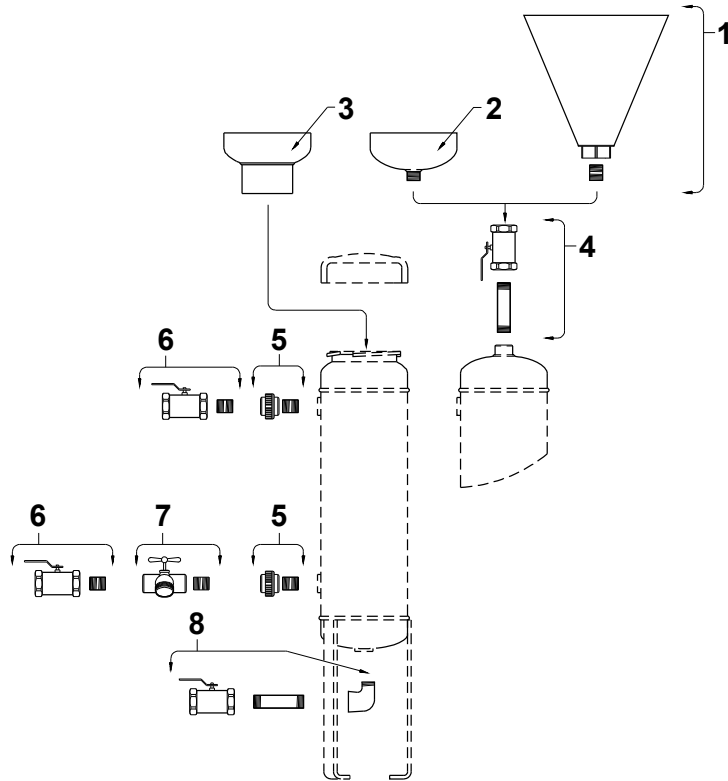

### SPECIFICATIONS

KEY	PART NUMBER	DESCRIPTION
1	3069P	PE FUNNEL: 10" diameter polyethylene fill funnel
2	3069	FUNNEL: 6" diameter carbon steel fill funnel
3	3218	FUNNEL: 6" diameter carbon steel fill funnel with spill guard
4	3142	FILL VALVE: 1" NPT 300 PSI brass ball valve and 5" black nipple
5	3079	UNION: 3/4" NPT 300 PSI black union valve and installation nipple
6	3141	ISOLATION VALVE: 3/4" NPT 300 PSI brass ball valve and installation nipple
7	3063	HOSE BIBB: 3/4" NPT 300 PSI hose bibb with installation tee and nipple
8	3143	DRAIN VALVE: 3/4" NPT 300 PSI brass ball valve with installation street elbow and nipple

### VALVE PACKAGES

PART NUMBER	DESCRIPTION	INCLUDES KEY NUMBERS
3138	Flat bottom valve package	(2) #5 (2) #6 (1) #7
3138F	Flat bottom valve package with fill funnel	(1) #3 (2) #5 (2) #6 (1) #7
3139	Dome bottom valve package	2) #5 (2) #6 (1) #8
3139F	Dome bottom valve package with fill funnel	(1) #3 (2) #5 (2) #6 (1) #8
3140	High pressure valve package with steel funnel	(1) #2 (1) #4 (2) #5 (2) #6 (1) #8
3140P	High pressure valve package with PE funnel	(1) #1 (1) #4 (2) #5 (2) #6 (1) #8

Note: All dimensions are +/- 1/8". All dimensions are subject to change without notice.

MANUFACTURING: Mixers, Bypass Feeders, Filter Feeders, Bromine Feeders, Sample Coolers, Sludge Traps, Separators, Separator Systems, Tank Stands, Tank Package Systems, Glycol Feed Systems, Coupon Racks, Control Stations, NEMA Enclosures, Custom Packaged Systems and Specialty Welding

P.O. Box 6207 | Garden Grove, CA 92846-6207 | 11800 Monarch St. | Garden Grove, CA 92841-2113 | Phone (714) 379-5519 | Fax (714) 379-5549  
Northern California Region | Phone (510) 487-5310 | Southwest Region | Phone (602) 470-1015 | Email: customerservice@jlwingert.com

[www.jlwingert.com](http://www.jlwingert.com)