

J.L. WINGERT CO.

P.O. Box 6207 • Garden Grove, CA 92846-6207 / 11800 Monarch Street • Garden Grove, CA 92841-2113
 Phone (714) 379-5519 • Fax (714) 379-5549 ■ Email: customerservice@jllwingert.com
 Northern California Region • Phone (510) 487-5310 ■ Southwest Region • Phone (602) 470-1015
 www.jllwingert.com

MANUFACTURING: Mixers, Bypass Feeders, Filter Feeders, Bromine Feeders, Sample Coolers, Sludge Traps, Separators, Separator Systems, Tank Stands, Tank Package Systems, Glycol Feed Systems, Coupon Racks, Control Stations, NEMA Enclosures, Custom Packaged Systems and Specialty Welding

Specification Sheet #102202 Rev. "C" (2/00)

FLOODED SUCTION KITS

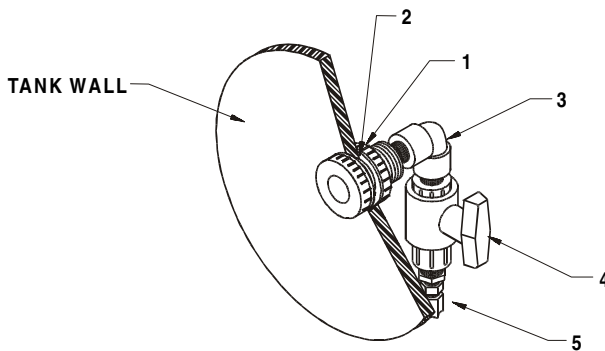

SPECIFICATIONS:

KEY	PART	DESCRIPTION
	L	1/4" TUBING FLOODED SUCTION KIT
	M	3/8" TUBING FLOODED SUCTION KIT
	N	1/2" TUBING FLOODED SUCTION KIT
	AA	1/2" NPT FLOODED SUCTION KIT
	CC	3/4" NPT FLOODED SUCTION KIT
	SS	2" NPT FLOODED SUCTION KIT
1		ADAPTER: Constructed of gray Sch. 80 PVC with both threaded and slip connections
2		GASKET: Standard gasket material is neoprene
3		ELBOW: Threaded and constructed of Sch. 80 PVC
4		BALL VALVE: Constructed of Sch. 80 PVC and compact in design with teflon ball valve seals
5		TUBING CONNECTOR: Constructed of Sch. 80 PVC on 1/2" tubing or natural polypropylene connectors on 1/4" and 3/8" tubing

TYPICAL USES

