

J.L. WINGERT CO.

P.O. Box 6207 • Garden Grove, CA 92846-6207 / 11800 Monarch Street • Garden Grove, CA 92841-2113
 Phone (714) 379-5519 • Fax (714) 379-5549 ■ Email: customerservice@jllwingert.com
 Northern California Region • Phone (510) 487-5310 ■ Southwest Region • Phone (602) 470-1015
 www.jllwingert.com

MANUFACTURING: Mixers, Bypass Feeders, Filter Feeders, Bromine Feeders, Sample Coolers, Sludge Traps, Separators, Separator Systems, Tank Stands, Tank Package Systems, Glycol Feed Systems, Coupon Racks, Control Stations, NEMA Enclosures, Custom Packaged Systems and Specialty Welding

Specification Sheet #052005 Rev. "A" (3/99)

"XFT" SERIES SEPARATORS (1/2" TO 2 1/2")

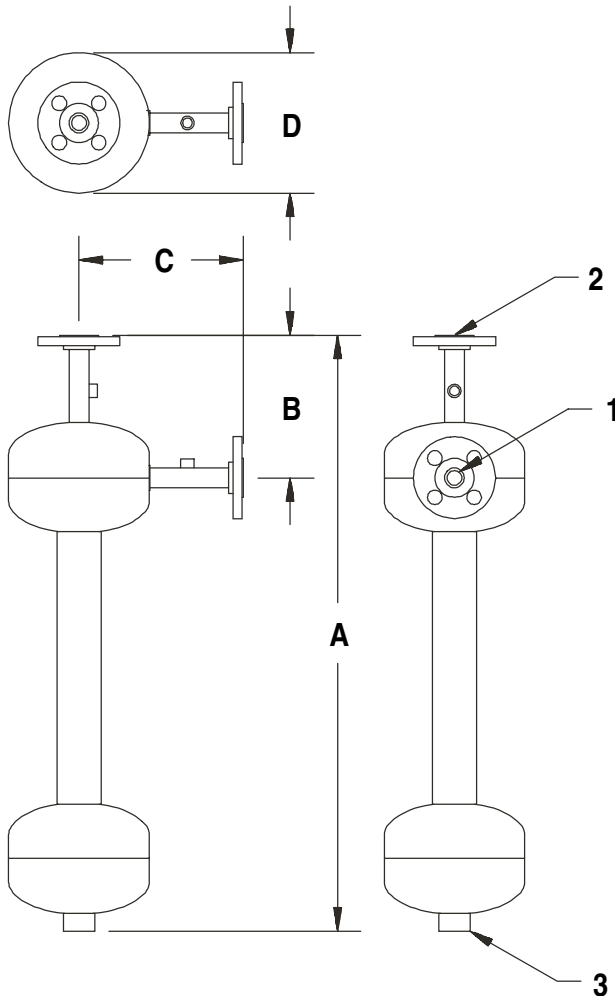

SPECIFICATIONS:

Body is constructed of carbon steel, ANSI 150#
 RF/SO inlet and outlet flanges and painted with water based enamel.

FLOW RANGE:

MODEL	4 PSI DROP	12 PSI DROP
XFT-0050	8 GPM	14 GPM
XFT-0075	14 GPM	25 GPM
XFT-0100	28 GPM	49 GPM
XFT-0125	49 GPM	84 GPM
XFT-0150	67 GPM	115 GPM
XFT-0200	90 GPM	157 GPM
XFT-0250	129 GPM	224 GPM

ACCESSORIES:

PART #	DESCRIPTION	SPEC. #
GK-1/8	Inlet and outlet pressure gauge kits	052207
PK-0075	3/4" manual purge kit	052205
PK-0150	1 1/2" manual purge kit	052205
BM-[]	Wall mount brackets	052012
RL-06	Three removeable legs	052013

MODEL SHOWN: XFT-0050

DIMENSIONS, CUBE, WEIGHT, PRESSURE & TEMPERATURE

KEY	XFT-0050	XFT-0075	XFT-0100	XFT-0125	XFT-0150	XFT-0200	XFT-0250
1	1/2" FLANGE	3/4" FLANGE	1" FLANGE	1 1/4" FLANGE	1 1/2" FLANGE	2" FLANGE	2 1/2" FLANGE
2	1/2" FLANGE	3/4" FLANGE	1" FLANGE	1 1/4" FLANGE	1 1/2" FLANGE	2" FLANGE	2 1/2" FLANGE
3	3/4" FNPT	3/4" FNPT	3/4" FNPT	3/4" FNPT	3/4" FNPT	1 1/2" FNPT	1 1/2" FNPT
A	25 7/16"	25 1/2"	25 7/16"	33"	33"	37 1/4"	37 1/4"
B	6 1/16"	6 1/8"	6 1/4"	8 1/8"	8 1/8"	7 1/2"	7 1/2"
C	7"	7"	7"	7"	7"	9 1/4"	9 1/4"
D	6"	6"	6"	6"	6"	10"	10"
CUBE	6" x 10" x 26"	6" x 10" x 26"	6" x 10" x 26"	6" X 10" X 33"	6" X 10" X 33"	10" X 13" X 38"	10" X 13" X 38"
WEIGHT	20 lbs.	24 lbs.	26 lbs.	30 lbs.	31 lbs.	57 lbs.	66 lbs.
PRESSURE	150 PSI maximum (10.3 bar)						
TEMPERATURE	200° F (93° C)						

Note: All dimensions are +/- 1/8". All weights are approximate. All dimensions are subject to change without notice.