

J.L. WINGERT CO.

P.O. Box 6207 • Garden Grove, CA 92846-6207 / 11800 Monarch Street • Garden Grove, CA 92841-2113
 Phone (714) 379-5519 • Fax (714) 379-5549 ■ Email: customerservice@jllwingert.com
 Northern California Region • Phone (510) 487-5310 ■ Southwest Region • Phone (602) 470-1015
 www.jllwingert.com

MANUFACTURING: Mixers, Bypass Feeders, Filter Feeders, Bromine Feeders, Sample Coolers, Sludge Traps, Separators, Separator Systems, Tank Stands,
 Tank Package Systems, Glycol Feed Systems, Coupon Racks, Control Stations, NEMA Enclosures, Custom Packaged Systems and Specialty Welding

Specification Sheet #042010 Rev. "C" (12/99)

MODEL ST SLUDGE TRAP

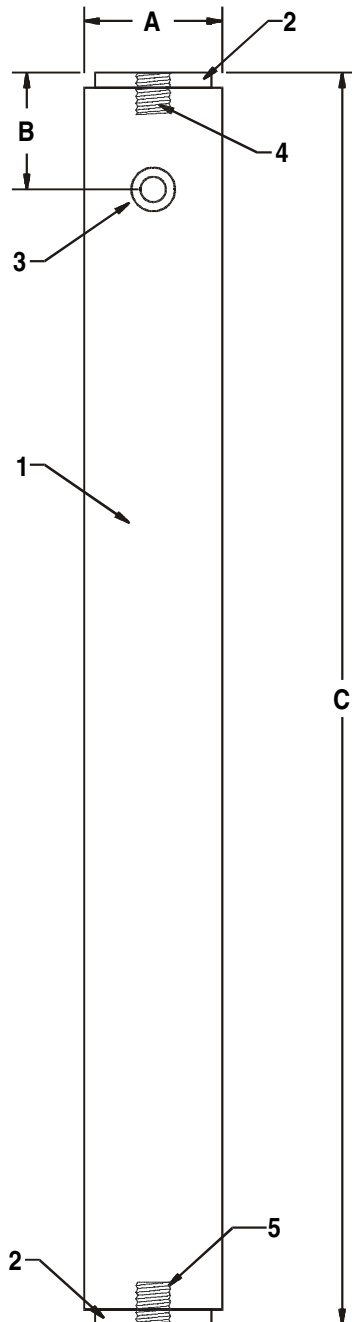

SPECIFICATIONS:

KEY	DESCRIPTION
1	BODY: Sch. 80 black pipe
2	END CAPS: C1215 carbon steel
3	INLET: 1/4" NPT
4	OUTLET: 1/4" NPT
5	DRAIN PORT: 1/2" NPT
MAX. PRESSURE	1500 PSI (102.7 BAR)
MAX. TEMPERATURE	600° F (316° C)

DIMENSIONS, WEIGHT & CUBE:

KEY	ST
A	2 3/8"
B	2 1/8"
C	21 1/2"
Weight	13 lbs.
Cube	5" x 5" x 27"

Note: All dimensions are +/- 1/8". All weights are approximate. All dimensions are subject to change without notice.