

# +GF+ SIGNET 24VDC Switching Power Supplies

3-7300-XX24.099 (A-8/00)

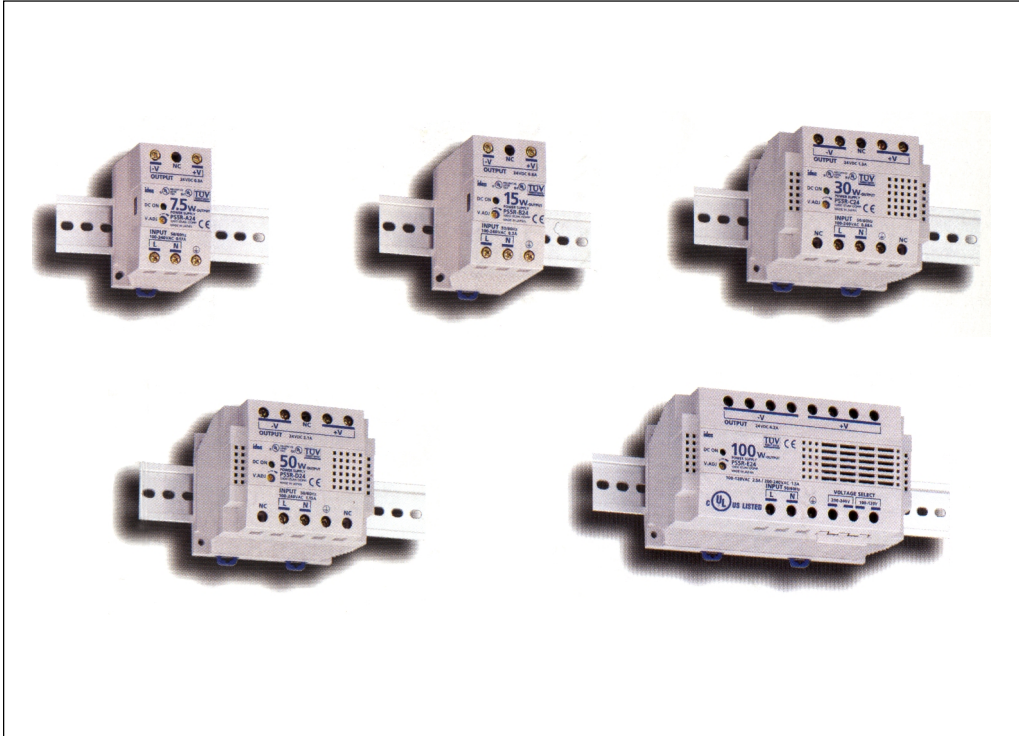

## Features

- Regulated 24VDC output voltage
- Five output capacities: 300mA, 600mA, 1.3A, 2.1A and 4.2A
- DIN rail or surface mount
- Universal AC input (85 to 264VAC)
- DC compatible input (105 to 370VDC)
- Fused input
- Auto resetting output overcurrent protection
- Unique spring-up, finger-safe terminals
- Short-circuit protection
- Output voltage adjust (+/- 10%)
- Light-weight plastic housing
- Quality standards: CE (according to both EMC and LVD), cUL and UL508 listed

## Description

+GF+ SIGNET 24VDC Switching Power Supplies provide regulated output voltage in compact and lightweight plastic housings that can be DIN Rail or surface mounted. The series includes five different output capacities from 300mA to 4.2A (7.5W to 100W), all of which accept universal AC line voltage input

and meet worldwide standards for performance and safety. So whether your power requirements are for a single system, multiple +GF+ SIGNET instruments or other devices requiring 24VDC operation, you have found the right supply for your specific application.

## Application

Perfect for use with:

- ProcessPro™, ProPoint™ and Intelk-Pro™
  - 2550 & 2560 Electro-magnetic Flow Sensors
  - 7000/7001/7002 Vortex Flow Sensors
- Also suitable for Electric Actuated Valves, including Solenoid

## Installation

The innovative terminals on these +GF+ SIGNET power supplies use a special spring-loaded screw. This makes installation as easy as pushing down and turning with a screwdriver. Installation time is cut in half since the screws do not need to be backed out to install wiring. The screws are held captive once installed and are 100% finger-safe. Screw terminals accept bare wire or ring or fork connectors.

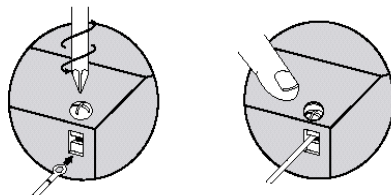

- 1) Insert the wire connector into the slot on the side of the power supply.
- 2) Using a Phillips screwdriver, push down and turn the screw.

# Dimensions

7300-1024

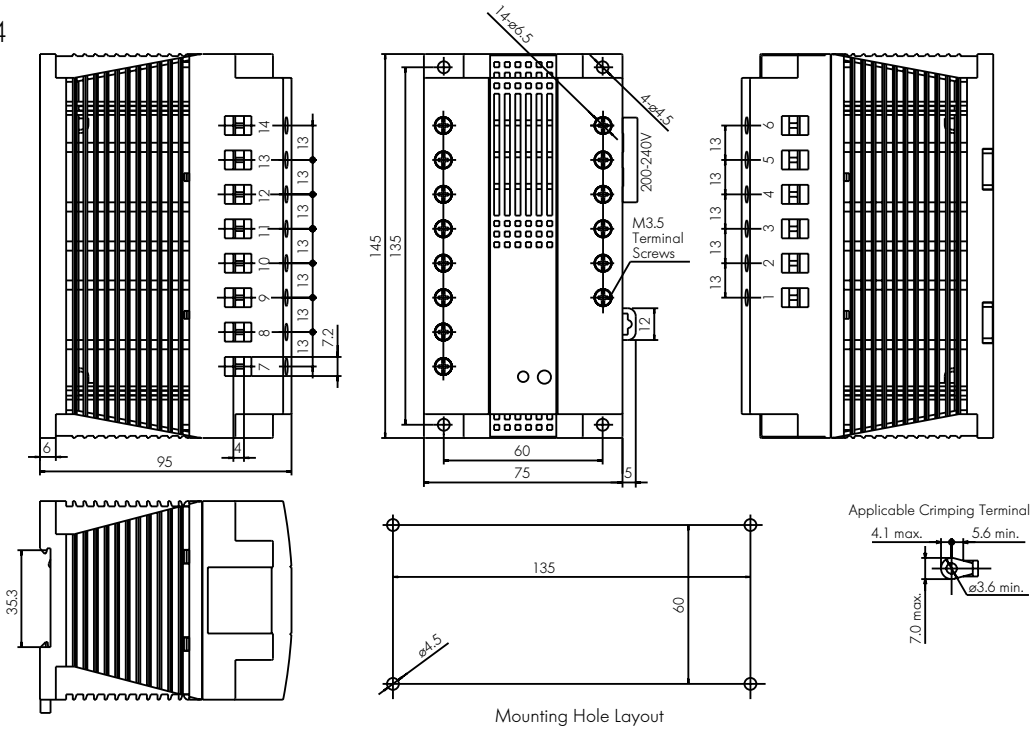

7300-3024  
7300-5024

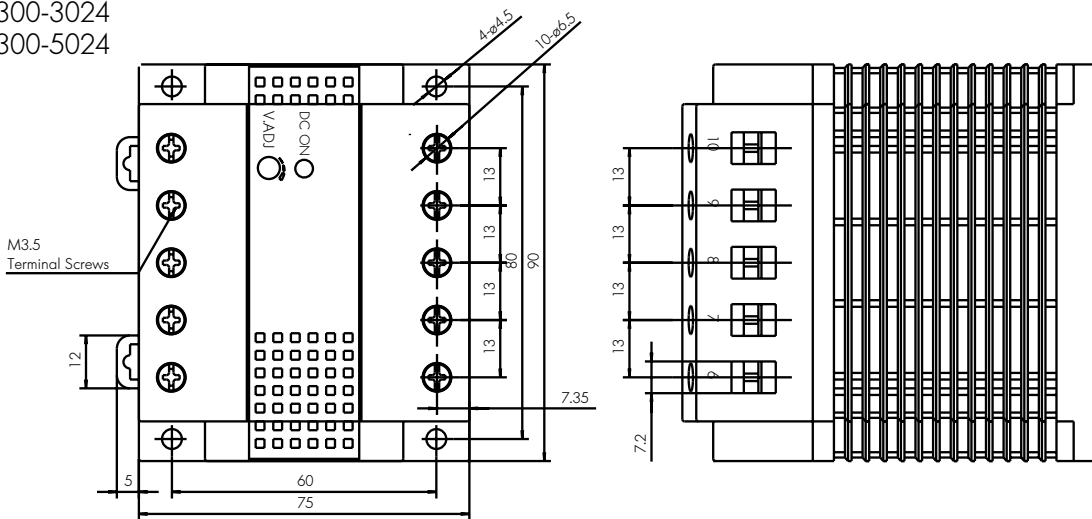

7300-1524

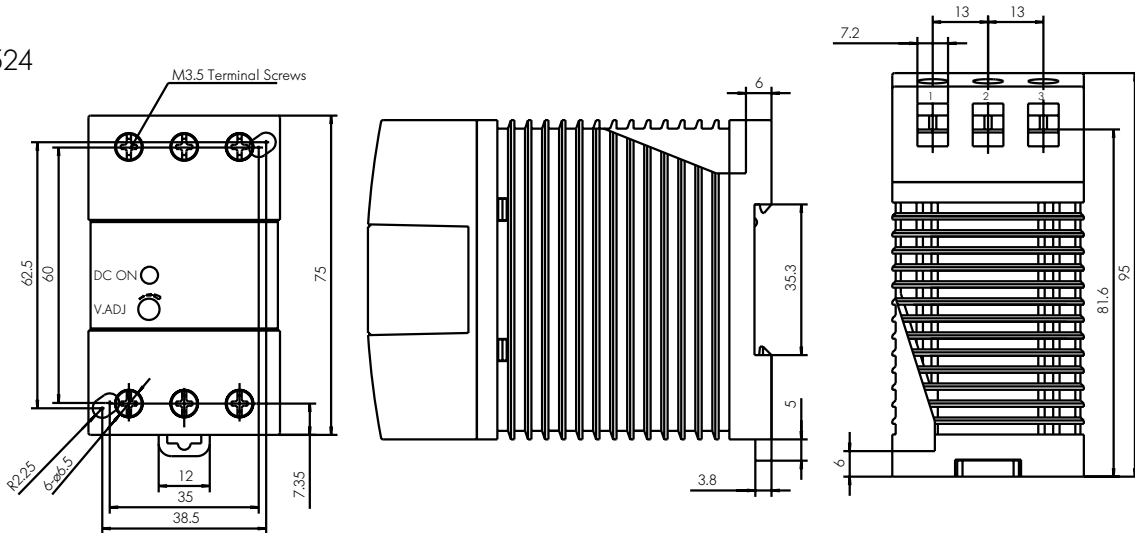

# Dimensions

7300-7524

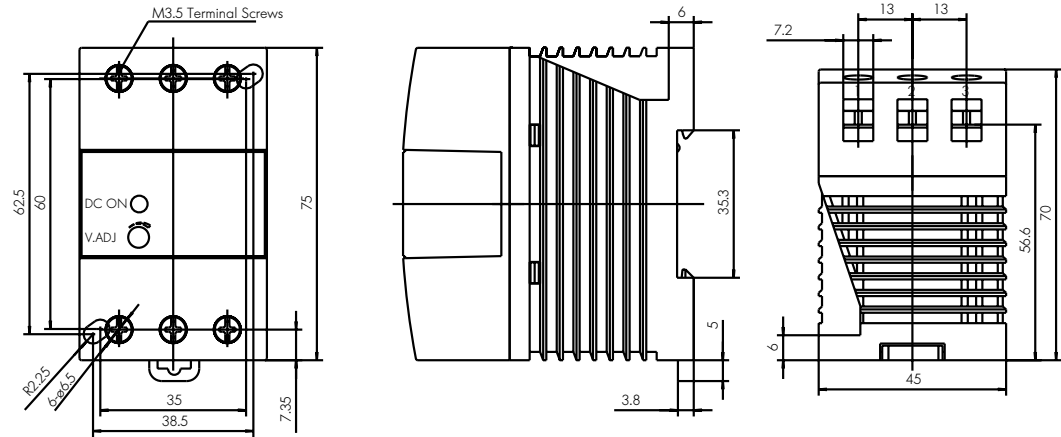

# Technical Data

Part Numbers:	7300-7524	7300-1524	7300-3024	7300-5024	7300-1024
Output Capacity	300mA	600mA	1.3A	2.1A	4.2A
<b>Input</b>					
Input Voltage	100 to 240VAC nominal (85 to 264VAC), 50/60Hz (47 to 63Hz) 110 to 340VDC nominal (105 to 370VDC)				
Input Current (typical)	0.17A @ 100VAC	0.3A @ 100VAC	0.68A @ 100VAC	1.15A @ 100VAC	2.5A @ 100VAC
Internal Fuse Rating	2A	2A	3.15A	3.15A	4A
Inrush Current	50A maximum (at cold start at 200VAC)				
Leakage Current (at no load)	0.75mA maximum (60Hz, measured in conformance with UL, CSA, VDE)				
Typical Efficiency	75% at 24V	79% at 24V	75% at 24V	79% at 24V	85% at 24V
Overvoltage Protection	Outputs turn off at 105% (typical)				
<b>Output</b>					
Voltage & Current Ratings	24V, 0.3A	24V, 0.6A	24V, 1.3A	24V, 2.1A	24V, 4.2A
Voltage Adjustments	± 10% (V.ADJ screw on top)				
Output Holding Time	20 minutes maximum (at full rated input and output)				
Rise Time	200 minutes maximum (at full rated input and output)				
Fluctuation due to Input Voltage change	0.4% maximum				
Fluctuation due to Load Change	1.5% maximum				
Fluctuation due to Ambient Temperature Change	0.05% maximum				
Ripple Voltage	2% peak to peak maximum (including noise)				
Overload Protection	120% typical (Zener-limiting)		120% typical, auto reset		
<b>General</b>					
Operation Indicator	LED				
Dielectric Strength	Between input and output terminals: 3,000VAC, 1 minute Between input terminals and housing: 2,000VAC, 1 minute Between output terminals and housing: 500VAC, 1 minute				
Insulation Resistance	Between input and output terminals/input terminals and housing: 100MΩ min. (500VDC megger)				
Termination	Spring-up, fingersafe terminals with captive M3.5 screws				
Materials	Housing: PPHOX (polyphenylene oxide)				
Mounting	DIN Rail or Surface Mount				
Weight	.40 lbs. (.18kg)	.48 lbs. (.22kg)	.92 lbs. (.42kg)	.98 lbs. (.44kg)	1.54 lbs. (.70kg)
Dimensions (L/W/H)	75/45/70mm 2.9/1.7/2.7 in.	75/45/95mm 2.9/1.7/3.7 in.	75/90/95mm 2.9/3.5/3.7 in.	75/90/95mm 2.9/3.5/3.7 in.	75/145/95mm 2.9/5.7/3.7 in.
Package Dimensions (L/W/H)	108/82/51mm 4.25/3.25/2.0 in.	133/89/51mm 5.25/3.5/2.0 in.	133/95/89mm 5.25/3.75/3.5 in.	133/95/89mm 5.25/3.75/3.5 in.	209/101/89mm 8.25/4.0/3.5 in.
<b>Environmental</b>					
Operating Temperature	-10 to 60°C (14 to 140°F) (see derating curves)				
Storage Temperature	-30 to 85°C (-22 to 185°F)				
Operating Humidity	20 to 90% relative humidity (no condensation)				
Vibration Resistance	45m/s <sup>2</sup> , 10 to 55Hz, 2 hours on each of 3 axes				
Shock Resistance	294m/s <sup>2</sup> , 3 shocks in each of 6 directions				

## Standards and Approvals

- Meets EMC Directives EN50081-2 & EN50082-2
- Meets LVD Directives EN60529 & EN60950
- UL508 Listed, UL & cUL approved, CE marked

## Ordering Information

Mfr. Part No.	Code	Description
7300-7524	159 000 687	24VDC Power Supply 7.5W, 300mA
7300-1524	159 000 688	24VDC Power Supply 1.5W, 600mA
7300-3024	159 000 689	24VDC Power Supply 30W, 1.3A
7300-5024	159 000 690	24VDC Power Supply 50W, 2.1A
7300-1024	159 000 691	24VDC Power Supply 100W, 4.2A

## Accessories

DIN rail, in one meter lengths (1000mm), and DIN rail clips are available. The standard packaging of these power supplies are to be fastened to DIN rails, and accessory clips will keep the supplies from sliding if the rail itself is mounted vertically, for example. Contact the factory for more details.

## Engineering Specifications

- The power supplies shall provide regulated 24VDC output voltage.
- The power supplies shall deliver no less than 300mA.
- Power supply mounting options shall include DIN Rail and surface mount.
- The power supplies must accept universal AC line-voltage input (85 to 264VAC), and must be DC compatible (105 to 370VDC).
- The power supply must feature auto resetting output overcurrent protection in addition to having fuse-protected inputs.
- The output voltage of the power supplies must be adjustable ( $\pm 10\%$ ).
- The power supplies shall feature spring-up, finger-safe terminals.
- The power supply housing must be constructed of non-conducting plastic PPHOX (polyphenylene oxide).
- The power supplies must meet the following performance and safety standards: cUL and UL508 listing, and CE (EMC Directives EN50081-2 and EN50082-2 and LDV Directives EN60529 and EN60950)
- The power supplies must feature LED operation indication.
- The power supply must be +GF+ SIGNET model 7300 24VDC Switching Power Supplies.

## For more information on these products, please contact your local sales company:

<b>A</b>	Georg Fischer Rohrleitungssysteme GmbH, Sandgasse 16, A-3130 Herzogenburg, Tel. 02782/56 43-0, Fax 02782/51 56
<b>AUS</b>	George Fischer IPS Pty Ltd., 186-190 Kingsgrove Road, Kingsgrove, NSW 2208, Tel. 02 9554 3977, Fax 02 9502 2561
<b>B/L</b>	Georg Fischer N.V./S.A., Digue du Canal 109-111 - Vaardijk 109-111, B-1070 Bruxelles/Brussel, Tél. 02/556 40 20, Fax 02/524 34 26
<b>CH</b>	Georg Fischer Rohrleitungssysteme (Schweiz) AG, Amsler-Laffon-Strasse 1, Postfach, CH-8201 Schaffhausen, Tel. 052/631 3026, Fax 052/631 2897
<b>D</b>	Georg Fischer GmbH, Daimlerstraße 6, Postfach 1154, D-73093 Albershausen, Tel. 07161/302-0, Telex 7278 67, Fax 07161/302259
<b>DK</b>	Georg Fischer A/S, Klintehøj Vænge 17, DK-3460 Birkerød, Tel. 42/81 1975, Fax 42/81 1622
<b>E</b>	Georg Fischer S.A., Sistemas de tuberías para la industria, Calle Isla de la Palma, 32 - Nave 1, E-28700 San Sebastián de los Reyes (Madrid), Tel. 91/663 80 00, Fax 91/663 81 76
<b>F</b>	George Fischer S.A., 105-113, rue Charles Michels, B.P.174, F-93208 Saint-Denis Cedex 1, Tél. 1/49 22 13 41, Fax 1/49 22 13 00
<b>GB</b>	George Fischer Sales Limited, Paradise Way, Coventry, CV2 2ST, Tel. 01203/53 55 35, Telex 330032, Fax 01203/53 04 50-51
<b>I</b>	Giorgio Fischer S.p.A., Via Sondrio 1, I-20063 Cernusco S/N (MI), Agente generale di vendita Tufira S.r.l., Tel. 02/92 18 61, Fax 02/92 14 07 85
<b>J</b>	Kubota George Fischer Ltd., 2-47, Shikitsuhashi, 1-chome, Naniwa-ku, Osaka 556, Tel. 6/648 2838, Telex 5267785, Fax 6/648 2565
<b>N</b>	Georg Fischer A.S., Bygdøy Allé 23, Postboks 3223 Elisenberg, N-0208 Oslo 2, Tel. 22/44 41 10, Fax 22/43 40 19
<b>PRC</b>	Georg Fischer Piping Systems, Ltd., No. 218 Kang Qiao Dong Road, Pudong Shanghai 201319 Tel. 121 58 13 33 33, Fax 231 58 13 33 66
<b>RA</b>	George Fischer Inc., Lavalle 2614, 1640 Martinez Buenos Aires, Tel. 01/798 74 01, Fax 01/798 40 74
<b>NL</b>	Georg Fischer N.V., Lange Veenteweg 19, Postbus 35, NL-8160 AA Epe, Tel. 0578678222, Fax 0578621768
<b>S/SF</b>	Georg Fischer AB, Box 113, S-12523 Alvsjö-Stockholm, Tel. 08/7274700, Fax 08/7492370
<b>SGP</b>	George Fischer Pte. Ltd., 15 Kaki Bukit Road 2, KB Warehouse Complex, SGP-417 845 Singapore/Singapore, Tel. 747 06 11, Fax 747 05 77
<b>USA*</b>	George Fischer Inc., 2882 Dow Ave., Tustin, CA 92780-7285, Tel. 714/731-8800, Toll Free 800/854-4090, Fax 714/731-4688, e-mail: info@us.piping.georgefischer.com, Internet: http://www.us.piping.georgefischer.com

\*Serving North, Central, and South America

## +GF+ SIGNET

Signet Scientific Company, 3401 Aerojet Avenue, El Monte, CA 91731-2882 U.S.A. • Tel. (626) 571-2770 • Fax (626) 573-2057  
For Worldwide Sales and Service, visit our website: [gfsignet.com](http://gfsignet.com) • e-mail: [info@gfsignet.com](mailto:info@gfsignet.com)