

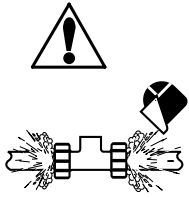

Caution!



1. Do not remove from pressurized lines.
2. Never install sensor without O-rings.
3. Confirm chemical compatibility before use.
4. Do not exceed maximum temperature/pressure specifications.
5. Wear safety goggles and faceshield during installation/service.
6. Failure to follow safety instructions could result in severe personal injury.

Contents

1. Installation/Mounting
2. Sensor Wiring
3. Calibration
4. Specifications
5. Parts and Accessories

1. Installation/Mounting

1. Install sensor with arrow pointing in the direction of flow. All mounting angles acceptable.
2. Slide union nut onto pipe or flexible tubing.
3. Install end connectors.
4. Hand tighten union nut to secure.

- Suitable for clear or opaque fluids. Suspended solids may cause mechanical failure.
- Upstream/downstream mounting requirements:

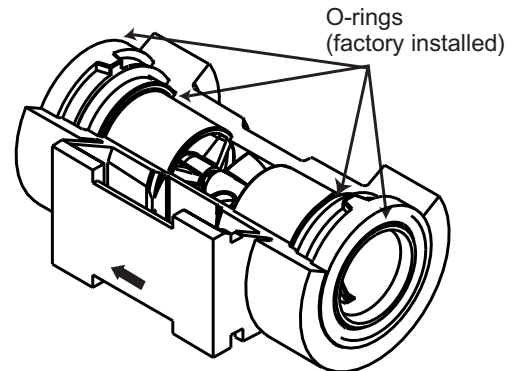
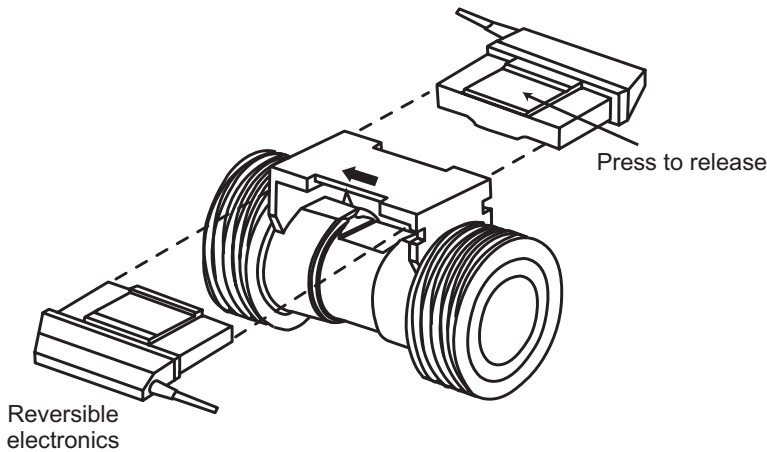
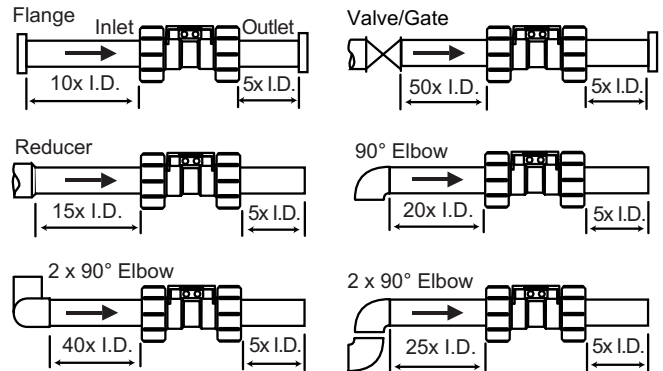
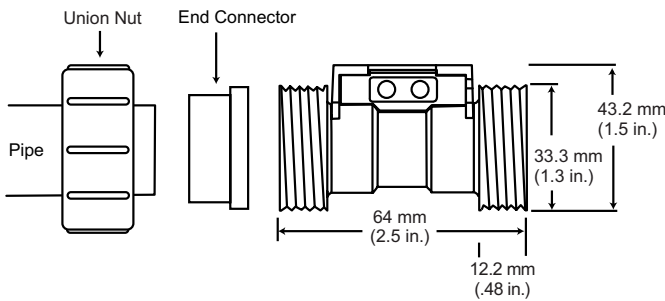

2. Sensor Wiring

Wiring Tips:

- Use 2-conductor twisted-pair shielded cable (Belden #8451 or equivalent) for sensor cable splices up to 300 m (1000 ft) max.
- Maintain cable shield through cable splice.
- Route sensor cable away from AC power lines.
- Use the 2535/2536 input card setting for +GF+ SIGNET Inteltek-Pro controllers.

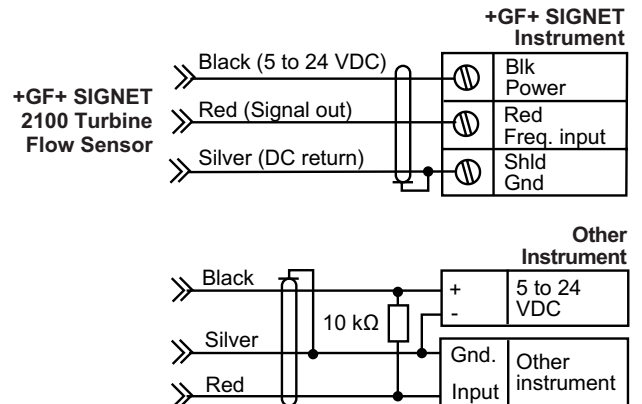

3. Calibration

Sensor Model	Connection Option	K-Factors: Pulses/U.S. Gallon	Pulses/Liter
High Flow Sensors 3-2100-1H, 2H	1/2" Pipe	1725	456
	1/2" Hose	1700	449
Low Flow Sensors 3-2100-1L, 2L	1/2" Pipe	12250	3236
	1/4" Hose	12800	3382
	3/8" Hose	13000	3435
	1/2" Hose	12500	3303

4. Specifications

General

Flow range: -L = 0.38 to 3.8 l/m (0.10 to 1 gpm)
 -H = 3 to 38 l/m (0.8 to 10 gpm)

Pipe size: DN 15 (1/2")
 Hose size: 1/2", 3/8", 1/4"
 Accuracy: ±3% of reading
 Repeatability: ±0.5% of reading
 Weight: 151 g (0.33 lbs)

Electrical

Power: 5 to 24 VDC @ 1.0 mA max.
 Reverse polarity protected

Output: Open collector, sinking, max 30 mA

Standards and Approvals
 CE, Manufactured under ISO 9001

Environmental

Materials

Sensor body/rotor: PVDF
 Shaft/bearings: Ceramic
 O-rings: -1 = FPM, -2 = EPDM
 Electronics box: PBT overmolded EVA
 Cable type: PVC jacketed, 2 conductor twisted pair with shield (22 AWG)
 Cable length: 4.6 m (15 ft.)

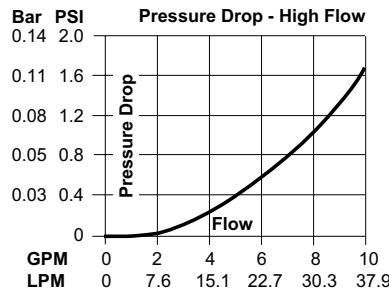
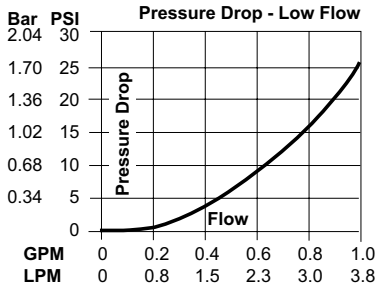
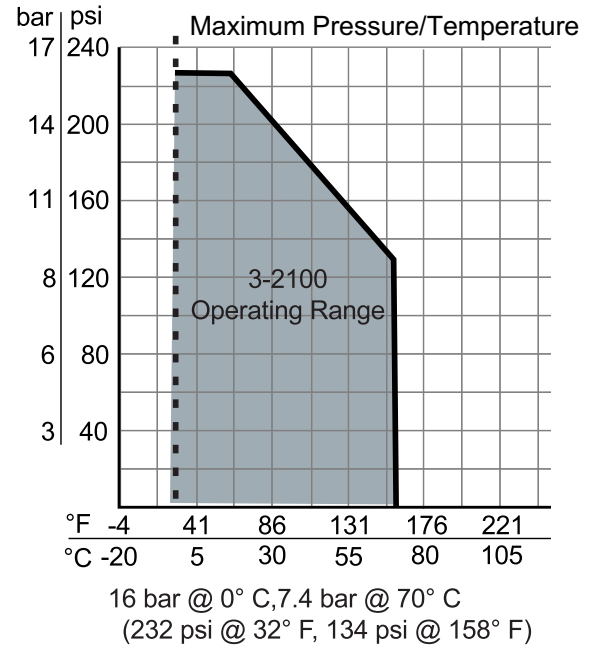

5. Parts and Accessories

	Part No.	+GF+ Code No.	Description
Turbine Body:	3-2100.390-1L	159.000.015	Replacement Lo Flow with FPM O-rings
	3-2100.390-1H	159.000.016	Replacement Hi Flow with FPM O-rings
	3-2100.390-2L	159.000.017	Replacement Lo Flow with EPDM O-rings
	3-2100.390-2H	159.000.018	Replacement Hi Flow with EPDM O-rings
	Electronics:	3-2100.390	159.000.014
O-rings:	1220-0018	159.000.019	O-rings (2) FPM
	1224-0018	159.000.020	O-rings (2) EPDM
	Connector Kits:	3-2100-31	159.000.005
3-2100-32		159.000.006	Hose Barb connector kit, PVDF, 3/8"
3-2100-33		159.000.007	Hose Barb connector kit, PVDF, 1/4"
3-2100-34		159.000.008	Fusion Socket connector, PVDF, DN 15
3-2100-35		159.000.009	Butt Fusion/IR connector kit, PVDF, DN 15
3-2100-36		159.000.010	Metric Socket connector kit, PVC, DN 15
3-2100-37		159.000.011	SCH 80 Socket connector kit, PVC, 1/2 in.
3-2100-38		159.000.012	NPT Thread Socket connector kit, PVC, 1/2 in.

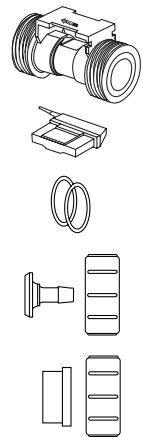

+GF+ SIGNET

Signet Scientific Company, 3401 Aerojet Avenue, El Monte, CA 91731-2882 U.S.A. • Tel. (626) 571-2770 • Fax (626) 573-2057
 For Worldwide Sales and Service, visit our website: www.gfsignet.com • Or call (in the U.S.): (800) 854-4090

